

H3G



- H3G load cells are available in the capacities 50kg~7.5t and 50lb~20Klb.
- Alloy steel, sealed by adhesive inside, oil-proof, waterproof and anti-corrosion, suitable for all kinds of environments.
- S beam design, tension and/or compression loading possible, easy installation, suitable for crane scale, mechanical conversion scale, hopper scale and other electronic weighing devices.
- Safe and anti-explosive product, can be used in atrocious environment and hazardous areas.

Features

- Capacity: 50kg~10t ; 50lb~20Klb
- High accuracy
- Alloy steel construction
- Low profile

Accessory

- HL-3-001 • HL-3-002
- HL-3-003 • HL-3-004 • HL-3-005

Specifications

Capacity	t lb	0.05/0.1/0.2/0.25/0.5/1/2.5/5/7.5					
		50/75/100/150/200/250/300/500/750/1K/1.5K/2K/2.5K/3K/5K/7.5K/10K/15K/20K					
Accuracy		C2	C3	A5S	A5M	B10S	B10M
Maximum number of verification intervals	f _{max}	2000	3000	5000	5000	10000	10000
Minimum load cell verification interval	V _{min}	E _{max} /5000	E _{max} /10000	E _{max} /15000	E _{max} /15000	E _{max} /10000	E _{max} /10000
Combined error	(%FS)	≤ ±0.030	≤ ±0.020	≤ ±0.018	≤ ±0.026	≤ ±0.035	≤ ±0.050
Creep	(%FS/30min)	≤ ±0.024	≤ ±0.016	≤ ±0.012	≤ ±0.017	≤ ±0.030	≤ ±0.040
Temperature effect on sensitivity	(%FS/10°C)	≤ ±0.017	≤ ±0.011	≤ ±0.009	≤ ±0.013	≤ ±0.030	≤ ±0.040
Temperature effect on zero	(%FS/10°C)	≤ ±0.023	≤ ±0.015	≤ ±0.010	≤ ±0.014	≤ ±0.030	≤ ±0.020
Output sensitivity	(mV)	3.0±0.008					
Input resistance	(Ω)	430±60					
Output resistance	(Ω)	351±2.0					
Insulation resistance	(MΩ)	≥5000(50VDC)					
Zero balance	(%FS)	1.0					
Temperature, compensated	(°C)	-10~+40					
Temperature, operating	(°C)	-35~+70					
Excitation, recommended	(V)	5~12(DC)					
Excitation, max	(V)	18(DC)					
Safe overload	(%FS)	150					
Ultimate overload	(%FS)	300					

Outline Dimension mm(inch)

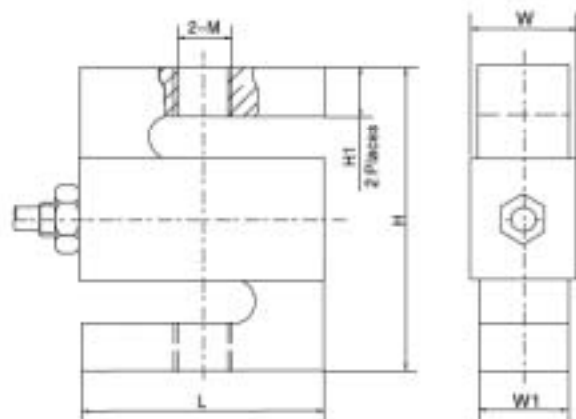

Capacity	Dimension mm	L	H	W1	W	M	H1
50kg-100kg		50.8	63.5	12.7	16.07	M8	
50lb-300lb	(2.0)	(2.5)	(0.5)	(0.63)		1/4-28UNF	
200kg-500kg		50.8	63.5	19.05	22.43	M12	10.16
500lb-1.5Klb	(2.0)	(2.5)	(0.75)	(0.85)		1/2-20UNF	(0.4)
1t		50.8	63.5	25.4	28.78	M12	
2.2-3Klb	(2.0)	(2.5)	(1.0)	(1.13)		1/2-20UNF	
2.5t		76.2	101.6	25.4	28.78	M20 x 1.5	15.2
3Klb	(3.0)	(4.0)	(1.0)	(1.13)		1/2-20UNF	(0.6)
5t		76.2	101.6	25.4	28.78	M20 x 1.5	20(0.79)
5Klb, 10Klb	(3.0)	(4.0)	(1.0)	(1.13)		3/4-16UNF	15.24(0.6)
7.5t		101.6	139.7	31.75	35.13	M24 x 2	30(1.18)
15Klb	(4.0)	(5.0)	(1.25)	(1.38)		1-14UNF	31(1.22)
20Klb		127	177.8	50.8	54.6	1 1/4 -12UNF	39.9
	(5.0)	(7.0)	(2.0)	(2.15)			(1.57)

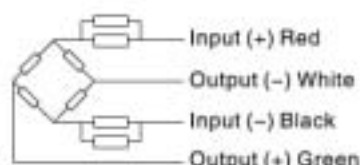

Wiring:

Adopt shielded, 4 conductor cable; Φ5mm
Standard cable length: 6m